

# COPPER PENN-CRIMPS® • TYPE BCU & BBCU

## Crimp splices for #8 stranded thru 2000 MCM

- ◆ Seamless, one piece, pure copper construction with tin plating assures maximum conductivity. Generous entrance chamfer provides easy cable insertion. Type BBCU has longer length barrel which permits extra crimps for additional assurance on heavy duty loads.
- ◆ Catalog number and conductor sizes marked on every piece insures positive identification.
- ◆ Positive cable stops insure proper insertion of conductors to full depth.
- ◆ Can be installed with existing crimping tools. Die color coding conforms to industry standards to insure proper connector/die selection

- ◆ and to provide for faster installation.
- ◆ BCU & BBCU Splices are suitable for use at voltages up to 35KV provided connector is taped in accordance with accepted practices, 5 KV is maximum voltage level in all bare splice applications.
- ◆ NEW FEATURE – UL/CSA approved with Versa-Crimp® tooling and wire ranges. Versa-Crimp® is a registered trademark of Hubbell Incorporated.
- ◆ Additional wire recommendations, see Master Catalog.



### COLOR-CODED COPPER COMPRESSION CONNECTORS



| Connector Family           | UL 486A/CSA 22.2 No. 65 Wire Range | UL 467 GROUNDING       |                     |               | CSA C22.2 NO. 41 GROUNDING |                     |               |
|----------------------------|------------------------------------|------------------------|---------------------|---------------|----------------------------|---------------------|---------------|
|                            |                                    | UL Grounding Max. Wire | Grounding & Bonding | Direct Burial | CSA Grounding Max. Wire    | Grounding & Bonding | Direct Burial |
| BLL, BBLU, BBLZ, BCU, BBCU | 8 Str.-2000 MCM                    | 500 MCM                | YES                 | YES           | 250 MCM                    | YES                 | YES           |

POWER: UL 486A, CSA C22.2 NO. 65  
GROUNDING & BONDING & DIRECT BURIAL : UL 467, CSA C22.2 NO. 41

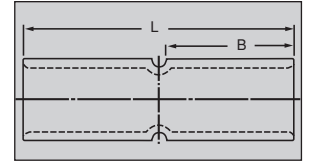

| Catalog Number | Copper Cond. Range† | Wire Diam. (in) ± | Approx. Dimensions (in inches) |        | Die Color Code | Crimping Tool Reference+++ |                  |              |                  |          |
|----------------|---------------------|-------------------|--------------------------------|--------|----------------|----------------------------|------------------|--------------|------------------|----------|
|                |                     |                   |                                |        |                | Penn-Union                 |                  | Alt. Tooling |                  |          |
|                |                     |                   |                                |        |                | PUC Dies                   | Pressure Setting |              | Burndy Index No. | T&B Die  |
| BCU-8          | 8 Str.              | .146              | 15/32                          | 1 1/16 | Red            | T-6*                       |                  |              | B-6              | 21       |
| BCU-6          | 6 Str.              | .184              | 13/16                          | 1 3/4  | Blue           | T-7*/T-374*                |                  |              | B-7              | 24       |
| BCU-5          | 5 Str.              | .206              | 13/16                          | 1 3/4  | Blue           | T-7*/T-374*                |                  |              | B-7              | -        |
| BCU-4          | 4 Str.              | .232              | 13/16                          | 1 3/4  | Gray           | T-8*/T-346*                |                  |              | B-8              | 29       |
| BCU-3          | 3 Str.              | .260              | 13/16                          | 1 3/4  | White          | T-9*                       |                  |              | B-9              | -        |
| BCU-2          | 2 Str.              | .292              | 7/8                            | 1 7/8  | Brown          | T-10                       |                  |              | B-10             | 33       |
| BCU-1          | 1 Str.              | .332              | 7/8                            | 1 7/8  | Green          | T-11/375                   | 2                |              | B-11             | 37       |
| BCU-1/0        | 1/0 Str.            | .375              | 7/8                            | 1 7/8  | Pink           | T-12/348                   |                  |              | B-12             | 42       |
| BCU-2/0        | 2/0 Str.            | .419              | 15/16                          | 2      | Black          | T-13                       |                  |              | B-13             | 45       |
| BCU-3/0        | 3/0 Str.            | .470              | 1                              | 2 1/8  | Orange         | T-14                       |                  |              | B-14             | 50       |
| BCU-4/0        | 4/0 Str.            | .528              | 1                              | 2 1/8  | Purple         | T-15                       | 5                | 5            | B-15             | 54       |
| BCU-025        | 250 MCM             | .575              | 1 1/16                         | 2 1/4  | Yellow         | T-16                       |                  |              | B-16             | 62       |
| BCU-030        | 300 MCM             | .634              | 1 1/16                         | 2 1/4  | White          | T-17*                      |                  |              | B-17             | 66H/66   |
| BCU-035        | 350 MCM             | .682              | 1 1/8                          | 2 3/8  | Red            | T-18/324                   | 7                | 7            | B-18             | 71H/71   |
| BCU-040        | 400 MCM             | .728              | 1 3/16                         | 2 1/2  | Blue           | T-19*/470*                 |                  |              | B-19             | 76H/76   |
| BCU-045        | 450 MCM             | .772              | 1 3/8                          | 2 7/8  | Blue           | T-19*/470*                 |                  |              | B-19             | 76H/76   |
| BCU-050        | 500 MCM             | .815              | 1 3/8                          | 2 7/8  | Brown          | T-20/299                   |                  |              | B-20             | 87       |
| BCU-060        | 600 MCM             | .893              | 1 3/8                          | 2 7/8  | Green          | T-22/472                   |                  |              | B-22             | 94H/94   |
| BCU-065        | 650 MCM             | .930              | 1 3/8                          | 2 7/8  | Black          | -                          | 9                | 9            | B-300            | 99       |
| BCU-075        | 750 MCM             | .999              | 1 5/8                          | 3 3/8  | Black          | T-24*/473                  |                  |              | B-24             | 106H/106 |
| BCU-080        | 800 MCM             | 1.031             | 1 5/8                          | 3 3/8  | Orange         | -                          |                  |              | B-25             | 107H/107 |
| BCU-100        | 1000 MCM            | 1.153             | 1 7/8                          | 3 7/8  | White          | -                          | 9***             | 9***         | B-27             | 125      |
| BCU-150        | 1500 MCM            | 1.412             | 2                              | 4 1/8  | Green          | -                          |                  |              | B-31             | -        |
| BCU-200        | 2000 MCM            | 1.632             | 2 1/4                          | 4 5/8  | Brown          | -                          |                  |              | B-34             | -        |

### LONG BARREL SPLICES

|          |          |       |         |       |        |             |      |      |       |          |
|----------|----------|-------|---------|-------|--------|-------------|------|------|-------|----------|
| BBCU-8   | 8 Str.   | .146  | 15/16   | 2     | Red    | T-6*        |      |      | B-6   | 21       |
| BBCU-6   | 6 Str.   | .184  | 1 1/8   | 2 3/8 | Blue   | T-7*/T-374* |      |      | B-7   | 24       |
| BBCU-4   | 4 Str.   | .232  | 1 1/8   | 2 3/8 | Gray   | T-8*/T-346* |      |      | B-8   | 29       |
| BBCU-3   | 3 Str.   | .260  | 1 1/8   | 2 3/8 | White  | T-9*        |      |      | B-9   | -        |
| BBCU-2   | 2 Str.   | .292  | 1 1/4   | 2 5/8 | Brown  | T-10        |      |      | B-10  | 33       |
| BBCU-1   | 1 Str.   | .332  | 1 3/8   | 2 7/8 | Green  | T-11/375    | 2    |      | B-11  | 37       |
| BBCU-1/0 | 1/0 Str. | .375  | 1 3/8   | 2 7/8 | Pink   | T-12/348    |      |      | B-12  | 42       |
| BBCU-2/0 | 2/0 Str. | .419  | 1 1/2   | 3 1/8 | Black  | T-13        |      |      | B-13  | 45       |
| BBCU-3/0 | 3/0 Str. | .470  | 1 1/2   | 3 1/8 | Orange | T-14        |      |      | B-14  | 50       |
| BBCU-4/0 | 4/0 Str. | .528  | 1 5/8   | 3 3/8 | Orange | T-15        | 5    | 5    | B-15  | 54       |
| BBCU-025 | 250 MCM  | .575  | 1 5/8   | 3 3/8 | Yellow | T-16        |      |      | B-16  | 62       |
| BBCU-030 | 300 MCM  | .634  | 2       | 4 1/8 | White  | T-17*       |      |      | B-17  | 66H/66   |
| BBCU-035 | 350 MCM  | .682  | 2       | 4 1/8 | Red    | T-18/324    | 7    | 7    | B-18  | 71H/71   |
| BBCU-040 | 400 MCM  | .728  | 2 1/8   | 4 3/8 | Blue   | T-19*/470*  |      |      | B-19  | 76H/76   |
| BBCU-050 | 500 MCM  | .815  | 2 1/4   | 4 5/8 | Brown  | T-20/299    |      |      | B-20  | 87       |
| BBCU-060 | 600 MCM  | .893  | 2 1/16  | 5 1/2 | Green  | T-22/472    |      |      | B-22  | 94H/94   |
| BBCU-065 | 650 MCM  | .930  | 2 3/4   | 5 5/8 | Pink   | -           | 9    | 9    | B-300 | 99       |
| BBCU-075 | 750 MCM  | .999  | 2 7/8   | 5 7/8 | Black  | T-24*/473*  |      |      | B-24  | 106H/106 |
| BBCU-080 | 800 MCM  | 1.031 | 2 15/16 | 6     | Orange | -           |      |      | B-25  | 107H/107 |
| BBCU-100 | 1000 MCM | 1.153 | 3       | 6 1/8 | White  | -           | 9*** | 9*** | B-27  | 125      |
| BBCU-150 | 1500 MCM | 1.412 | 3 3/16  | 6 1/2 | Green  | -           |      |      | B-31  | -        |
| BBCU-200 | 2000 MCM | 1.632 | 3 7/16  | 7     | Brown  | -           |      |      | B-34  | -        |

**NEW FEATURE!**  
**NOW LISTED FOR GROUNDING, BONDING & DIRECT BURIAL APPLICATIONS**

+ Concentric, compressed and compact stranding.  
 ++ For conversion to metric range see Master Catalog  
 +++ For additional tool references see Master Catalog

\* Consult factory for availability of dies not available at this time.