

ALUMINUM PENN-CRIMPS® • TYPE BLUA

Crimp lugs for #6 stranded thru 1000 MCM copper or aluminum wire or cable

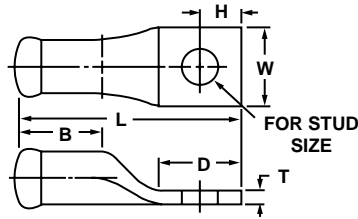

FIG. 1

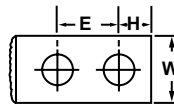

FIG. 2

Seamless, one piece, pure aluminum construction with tin plating assures maximum conductivity. Generous entrance chamfer provides easy cable insertion. The barrels are filled with Cual-Aid® and capped at factory to eliminate the need for separate application of Cual-Aid® to the conductor. Wire brushing of aluminum conductor is required. This assures a stable cool running joint. End of cable is protected from environmental hazards by completely closed transition.

Catalog number and conductor size marked on every piece to insure positive identification.

Can be installed with existing crimping tools.

Color coding conforms to industry requirements to insure proper connection/die selection and to provide for faster installation.

Catalog Number	Cond. Range†	Color Code	Wire Dia. (in) ‡	Stud Size	Fig. No.	Approximate Dimensions (in inches)							Crimping Tool Reference				
						L	B	D	E	H	T	W	Alt. Tooling		Penn-Union		
													Burndy Index No.	T&B Die	PUC Dies	Pressure Setting TDY-1 TDY-U	
BLUA-8S•	8 Str.	Blue	.146	1/4	1	1 9/16	9/16	5/8	—	1/4	1/8	1/2	B-374	TBM-5	T-374*	2	
BLUA-6S	6 Str.	Gray	.184	1/4	1	1 53/64	11/16	51/64	—	3/8	1/8	1/2	B-346		T-346*		
BLUA-6S2				5/16	1	—	—	—	—								
BLUA-4S3	4 Str.	Green	.232	1/4	1	1 57/64	7/8	51/64	—	25/64	11/64	19/32	B-375		T-11/375		
BLUA-4S2				5/16	1	—	—	—	—								
BLUA-2S3	2 Str.	Pink	.292	1/4	1	1 29/32	—	23/32	—	11/32	—	—	B-348	T-12/348			
BLUA-2S4				5/16	1	1 31/32	7/8	25/32	—	3/8	7/32	23/32					
BLUA-2S				3/8	1	2 3/32	—	7/16	—	—	—	—					
BLUA-1S1	1 Str.	Gold	.332	1/4	1	2 11/64	7/8	55/64	—	25/64	15/64	25/32	B-471	T-471*			
BLUA-1S3				5/16	1	—	—	—	—	—	—	—					
BLUA-1S				3/8	1	2 17/32	—	7/16	—	—	—	—					
BLUA-1S2				1/2	1	2 33/64	29/32	1 3/8	—	11/16	11/64	25/32					
BLUA-1D1				1/2	2	4 3/64	—	2 29/32	1 3/4	9/16	—	—					
BLUA-1/OS2	1/0 Str.	Tan	.375	1/4	1	2 3/32	—	25/32	—	11/32	—	—	B-296	50	T-296	2	
BLUA-1/OS3				5/16	1	2 5/32	—	3/8	—	—	—						
BLUA-1/OS				3/8	1	2 7/32	—	7/16	—	—	—						
BLUA-1/OD1				3/8	2	3 17/32	1	1 7/8	1	3/8	13/64	27/32					
BLUA-1/OD2				3/8	2	3 27/32	—	2 3/16	1 1/16	5/8	—	—					
BLUA-1/OS1				1/2	1	2 5/8	—	1 1/8	—	9/16	—	—					
BLUA-1/OD3				1/2	2	4 9/16	—	2 29/32	1 3/4	9/16	—	—					
BLUA-2/OS4	2/0 Str.	Olive	.419	1/4	1	2 1/4	—	25/32	—	11/32	—	—	B-297	54	T-297	5	5
BLUA-2/OS5				5/16	1	2 5/16	—	3/8	—	—	—						
BLUA-2/OS1				3/8	1	2 5/8	1 3/32	1 13/64	—	5/8	1/4	15/16					
BLUA-2/OD2				3/8	2	3 3/8	—	1 7/8	1	3/8	—	—					
BLUA-2/OS				1/2	1	2 5/8	—	1 5/32	—	9/16	—	—					
BLUA-2/OD				1/2	2	4 21/32	—	2 29/32	1 3/4	9/16	—	—					
BLUA-3/OS5				3/0 Str.	Ruby	.470	5/16	1	2 19/32	—	27/32	—					
BLUA-3/OS2	3/8	1	2 13/16				—	1 1/16	—	7/16	—	—					
BLUA-3/OD1	3/8	2	3 29/32				1 1/4	1 7/8	1	3/8	9/32	1 1/16					
BLUA-3/OS	1/2	1	2 29/32				—	1 5/32	—	9/16	—	—					
BLUA-3/OD	1/2	2	4 15/16				—	2 29/32	1 3/4	9/16	—	—					
BLUA-4/OS3	4/0 Str.	White	.528	5/16	1	2 21/32	—	27/32	—	3/8	—	—	B-298	66	T-298	5	5
BLUA-4/OS5				3/8	1	2 31/32	—	1 13/64	—	5/8	—	—					
BLUA-4/OD2				3/8	2	4 7/32	1 5/16	2 1/16	1	7/16	5/16	1 3/16					
BLUA-4/OS				1/2	1	2 31/32	—	1 5/32	—	9/16	—	—					
BLUA-4/OD				1/2	2	5 1/16	—	2 29/32	1 3/4	9/16	—	—					
BLUA-4/OS4				5/8	1	3 9/32	—	1 15/32	—	23/32	—	—					

*Not UL Listed. †For conversion to metric range, see page 175. *Consult factory for availability of dies. Not available at this time. ‡Concentric, compressed and compact stranding.

ALUMINUM PENN-CRIMPS® • TYPE BLUA

Continued from preceding page

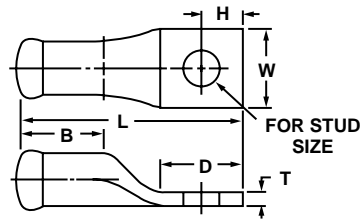

FIG. 1

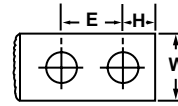

FIG. 2

BLUA LUGS ARE SUITABLE FOR USE AT VOLTAGES UP TO 35KV.

Catalog Number	Cond. Range†	Color Code	Wire Dia. (in) ‡	Stud Size	Fig. No.	Approximate Dimensions (in inches)							Crimping Tool Reference					
						L	B	D	E	H	T	W	Alt. Tooling		Penn-Union			
													Burndy Index No.	T&B Die	PUC Dies	Pressure Setting TDY-1 TDY-U		
BLUA-025S2	250 MCM	Red	.575	3/8	1	3		1 1/16	—	3/8			B-324	71	T-18/324	5	5	
BLUA-025D1				3/8	2	4		2 1/16	1	7/16								
BLUA-025S				1/2	1	3 7/16	1 13/16	1 1/2	—	5/8		1 1/32						1 9/32
BLUA-025D				1/2	2	5 3/16		2 29/32	1 3/4	9/16								
BLUA-025S3				5/8	1	3 7/16		1 1/2	—	23/32								
BLUA-030S2	300 MCM	Blue	.634	3/8	1	3 7/16		1 1/4	—	3/8			B-470	76	T-470*	5	5	
BLUA-030D1				3/8	2	4 15/32		2 3/8	1	7/16								
BLUA-030S1				1/2	1	3 11/16	1 1/2	1 1/2	—	1 1/16	3/8	1 3/8						
BLUA-030D				1/2	2	5 5/16		2 29/32	1 3/4	9/16								
BLUA-030S				5/8	1	3 21/32		1 15/32	—	23/32								
BLUA-035D1	350 MCM	Brown	.682	3/8	2	4 7/16		2 1/16	1	7/16			B-299	87	T-20/299	7	7	
BLUA-035S1				1/2	1	3 7/8	1 5/8	1 1/2	—	1 1/16	3/8	1 17/32						
BLUA-035D				1/2	2	5 9/32		2 29/32	1 3/4	9/16								
BLUA-035S				5/8	1	3 7/8		1 1/2	—	1 1/16								
BLUA-040D1	400 MCM	Green	.728	3/8	2	5 3/32		2 1/16	1	7/16			B-472	94	T-22/472	7	7	
BLUA-040S2				1/2	1	4 17/32		1 1/2	—	1 1/16								
BLUA-040D2				1/2	2	6 13/32	1 13/16	3 3/8	1 3/4	3/4	7/16	1 5/8						
BLUA-040S3				5/8	1	4 27/32		1 13/16	—	7/8								
BLUA-040D				5/8	2	6 1/4		3 7/32	1 3/4	23/32								
BLUA-050D1	500 MCM	Pink	.815	3/8	2	4 7/8		2 1/16	1	7/16			B-300	106	T-300	9	9	
BLUA-050S2				1/2	1	4 5/16		1 1/2	—	1 1/16								
BLUA-050D2				1/2	2	6 3/16	1 7/8	3 3/8	1 3/4	3/4	15/32	1 13/16						
BLUA-050S3				5/8	1	4 5/8		1 13/16	—	7/8								
BLUA-050D				5/8	2	6 1/32		3 7/32	1 3/4	23/32								
BLUA-060D1	600 MCM	Black	.893	3/8	2	5 3/16		2 1/16	1	7/16			B-473	115	T-473	9	9	
BLUA-060D2				1/2	2	6 11/32	2	3 7/32	1 3/4	3/4	32/64	1 31/32						
BLUA-060S1				5/8	1	5 5/32		2 1/32	—	1								
BLUA-060D				5/8	2	6 11/32		3 7/32	1 3/4	23/32								
BLUA-075D1	750 MCM	Red	.999	1/2	2	6 13/32		3 7/32	1 3/4	3/4			B-301	130	—	9	9	
BLUA-075S1				5/8	1	5 3/8	2 1/4	2 3/16	—	1	9/16	2 3/16						
BLUA-075D				5/8	2	6 13/32		3 7/32	1 3/4	23/32								
BLUA-080D1	800 MCM	Gray	1.031	1/2	2	7 1/8		3 7/32	1 3/4	3/4			B-474	140	—	9	9	
BLUA-080S1				5/8	1	6 13/32	2 5/16	2 1/2	—	1	19/32	2 1/4						
BLUA-080D				5/8	2	7 1/8		3 7/32	1 3/4	23/32								
BLUA-100D2	1000 MCM	Brown	1.153	1/2	2	7 1/16		3 7/32	1 3/4	3/4			B-302	150	—	9	9	
BLUA-100S1				5/8	1	6 23/32	2 9/16	2 1/2	—	1	1 1/16	2 1/2						
BLUA-100D				5/8	2	7 7/16		3 7/32	1 3/4	23/32								

†For conversion to metric range, see page 175.

* Consult factory for availability of dies. Not available at this time.

‡Concentric, compressed and compact stranding.